

Welcome to the **7th Annual**

CHATFIELD CHALLENGE

9/21/10

5K HIGH SCHOOL CROSS COUNTRY INVITATIONAL

hosted by

Chatfield Senior High School Cross Country Team

CSHS Athletic Director: Chad Broer

CSHS Cross Country Team Coaches: Don Daniels, Jeff Mages, Sara Smutz

at

DENVER BOTANIC
GARDENS

8500 Deer Creek Canyon Rd
Littleton, CO 80128
(Across Wadsworth Blvd from Chatfield State Park)
303.973.3705

Chatfield

**NO PETS ALLOWED
INTO PARK—
Advise your parents &
spectators**

AFTER THE RACE...

Get Lost in the Gigantic Corn Maze! Take advantage of the Corn Maze after the race. Anyone attending the Chatfield Challenge can get a discounted admission to the corn maze for only \$5.00—GOOD ANYTIME thru October 31!! (See Page 7) Open on Race Day from 4:00-7:30 p.m.

7th Annual

CHATFIELD CHALLENGE

RACE SCHEDULE

9/21/10

- 3:25 — NATIONAL ANTHEM
- 3:30 — FRESHMEN BOYS
- 3:40 — FRESHMEN GIRLS
- 4:00 — VARSITY BOYS (*up to 7 runners*)
- 4:10 — VARSITY GIRLS (*up to 7 runners*)
- 4:30 — OPEN #1 BOYS *Start Line Teams #1 — #25*
- 4:40 — OPEN #1 GIRLS *Start Line Teams #1 — #25*
- 5:05 — OPEN #2 BOYS *Start Line Teams #26 — #50*
- 5:15 — OPEN #2 GIRLS *Start Line Teams #26 — #50*
- 6:00 — VARSITY AWARDS CEREMONY—TOP 10 PLACES & TEAM TROPHIES

ENTRY FEES

- \$90.00 per team or \$130.00 for both Boys & Girls teams
- Send Entry Fee payment to Chatfield Senior High School: 7227 S. Simms, Littleton, CO 80127
- Make Check payable to: "CSH-CHATFIELD CHALLENGE". (Call Deba Larson at CSHS, 303-982-3555, for details.)

REGISTRATION

Register online at www.Sydexsports.com by September 16, 2010. With 50 teams competing this year, **all runners must be pre-registered for bar-code management.** See next page for instructions.

TEAM RACE PACKET

- *Runner Bar Code Tags (based on your Team as pre-registered) and safety pins.*
- *Course Map*
- *Pick up by 3:15 p.m. at the "Red Barn". First Race @ 3:30 p.m. at open field near the Pumpkin Patch.*
- *Runner Bar Code Tags to be pinned on the Runner's upper right-side chest area.*

Registration Deadline is September 16, 2010

INSTRUCTIONS to Free ON-LINE REGISTRATION

Go to website www.sydexsports.com, and click on “**XC Online Meet Entries**”.

The main page for Online Entries appears. Click on the second button, “**Roster Setup/Send Entries to a Meet**” (**Attending Coach**).

The login screen appears. First-time users, click “**Register as New User**” (toward bottom of screen), fill in the fields, and click Proceed. If you are a returning user, type in your User Name and Password. Click “**Login & Proceed to Meet Selection.**” The next screen asks for your team information. Fill in using the **team code provided you in the e-mail with these instructions** and then proceed with the on-screen directions.

On the Meet Selection screen, select the “**09/21/10 - 2010 CHATFIELD CHALLENGE**” meet then click “**Proceed to Add/Change Rosters...**”.

You are now successfully logged into the meet. Please review the meet information, taking note of the “Special Instructions”.

Enter your Men’s/Women’s rosters with the “**View/Edit Roster**” buttons. *For this event, Class/Grades must be designated.*

Once you’ve entered your roster, put athletes into events with the “**Add Entries to Events**” buttons. Highlight name & click “**Add**” or click “**Add All**” button to move entire roster into the Event. Click “**Go to Next Event**” button and continue designating runners into appropriate races. Click the “**Confirm**” button when you are finished and repeat to add remaining roster.

After all the athletes are in events, you may view your work by returning to the previous screen and clicking “**View a List of Your Entries**”.

Click “**Email your Entries to Host**”. You may send this email more than once, if necessary.

If you have questions regarding registration, please call Joan Gorshing, (303) 988-6659 or e-mail jgorshing@e2psi.com.

See you at the Challenge!

7th Annual CHATFIELD CHALLENGE 9/21/10

DENVER BOTANIC GARDENS AT CHATFIELD is a picturesque nature preserve among the grasslands, ponds and cottonwood banks of Deer Creek. Facilities include nature trails, a corn maze, a wildlife observation area, display gardens, educational exhibits, a historical farm, a 19th century one-room schoolhouse, working beehives and picnic areas.

*Please note: **NO PETS ALLOWED ON PREMISES. Please convey this to your parents & spectators.***



DIRECTIONS

- C-470 to Wadsworth Blvd (CO-121) exit.
- Proceed south to the first stop-light at Deer Creek Canyon Road.
- Take first right onto Deer Creek Canyon Road and drive 1/4 mile.
- Denver Botanic Gardens at Chatfield is on your left at 8500 Deer Creek Canyon Road.

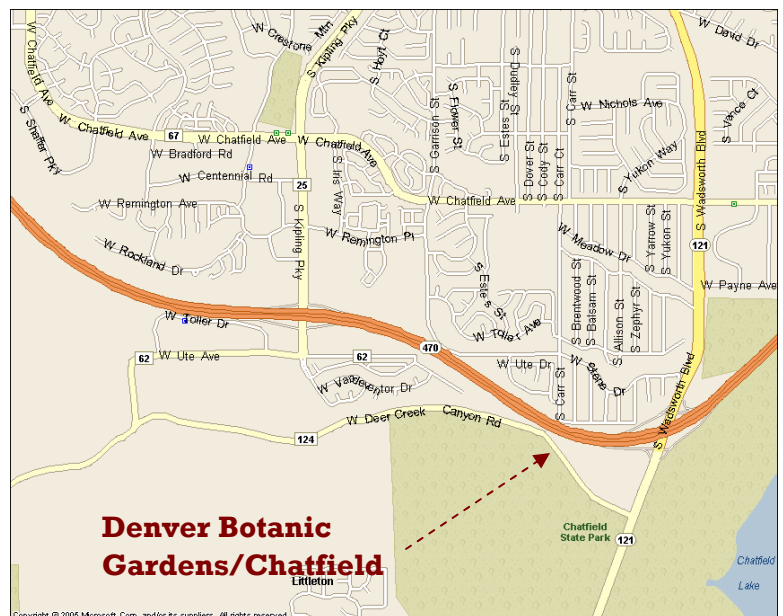

COURSE DESCRIPTION

The Race Course is an Open Cross Country Course, a flat, fast 5K Trail that loops throughout the DBG Grounds. From the Start Line, the Runners head out onto the Back DBG Farm Road, out past the backsides of Pond #1 & Pond #2, past the Pump House, and along the backsides of Pond #3 & #4, staying on to the Back DBG Farm Road over to the Road Bridge; after crossing the Road Bridge, the Runners stay to the right and come onto the main Asphalt Sidewalk at the DBG Fence Line; on the Asphalt Sidewalk, the Runners will make a right turn out on to the “old, beat up” Deer Creek Canyon Road, and then up and back on the Trail Adder Loop where they will pass the Mile #1 Marker, and then down the approximate 1200-Ft. straight-away between the Evergreen Tree Line; then it’s a right turn on to the Asphalt Sidewalk over to Bridge #1; after crossing over Bridge #1, it’s a right turn over to the Dark Trail, with a right turn at the Children’s Play Area / Tree House; passing the Tree House and just before the Bridge @ the Ranch, the Runners will make a sharp left turn to cruise along the grass trail back to the Deer Creek Dam and out past the outdoor Wedding Chapel area, where they will connect on to the Trail which runs behind the Administration Building / Nature Center / Red Barn area; at the end of this Trail by the end of the Storage Barn, it’s a left turn down through Deer Creek and back up to take a right turn back on to the Asphalt Sidewalk, running past the Mile #2 Marker; at the Roberts Riparian Trail Stone Marker, it’s a right turn onto the Roberts Riparian Front Trail #1, running past Bridge #2, and back out for a right turn back on to the Asphalt Sidewalk; it’s then a right turn into the Woods on the Roberts Riparian Front Trail #2, passing Bridge #3 and around the corner and up the only hill on the Course; at the end of the Front Trail #2, it’s a hard right and on across the Road Bridge and a right turn onto the Shubert Wetlands Back Trail where they come back past Bridge #3 and run along the front-side of the four Ponds, coming out off of the Trail at Bridge #2; then it’s on to the Back DBG Farm Road for the sprint to the Finish Line located in the yard out in front of the Red Barn.

AWARDS

- **VARSITY TEAMS:** 1st & 2nd Place Trophies (Presented at Awards Ceremony)
- **TOP THIRTY RUNNERS VARSITY, OPEN & FRESHMEN RACES** (Ribbons presented at end of the Chute)
- **TOP TEN VARSITY**—Race Day T-Shirts (Presented at Awards Ceremony)
- **TOP FIVE OPEN**—Race Day T-Shirts (Presented at Awards Ceremony)
- **TOP FIVE FRESHMEN**—Race Day T-Shirts (Presented at Awards Ceremony)

FIRST AID

Provided by 3 bike medics from the Littleton Fire Department and Chatfield Sr. High School Trainer.

RESTROOM FACILITIES

- Permanent Restroom Facility near School House
- Port-a-lets at Start/Finish area

ACKNOWLEDGEMENTS

We would like to thank the following individuals and businesses for their support and contribution to this event.

Chatfield Sr. High CC Team Parents

SweatVac Apparel

Colorado Credit Union

Sydex Sports

E Squared Power Systems, Inc.

Denver Botanical Gardens/Chatfield Management:

Outback Steakhouse

Larry Vickerman, Director & Chris Warford, Coordinator

**"CHATFIELD CHALLENGE"
5K Cross Country Trail Map**

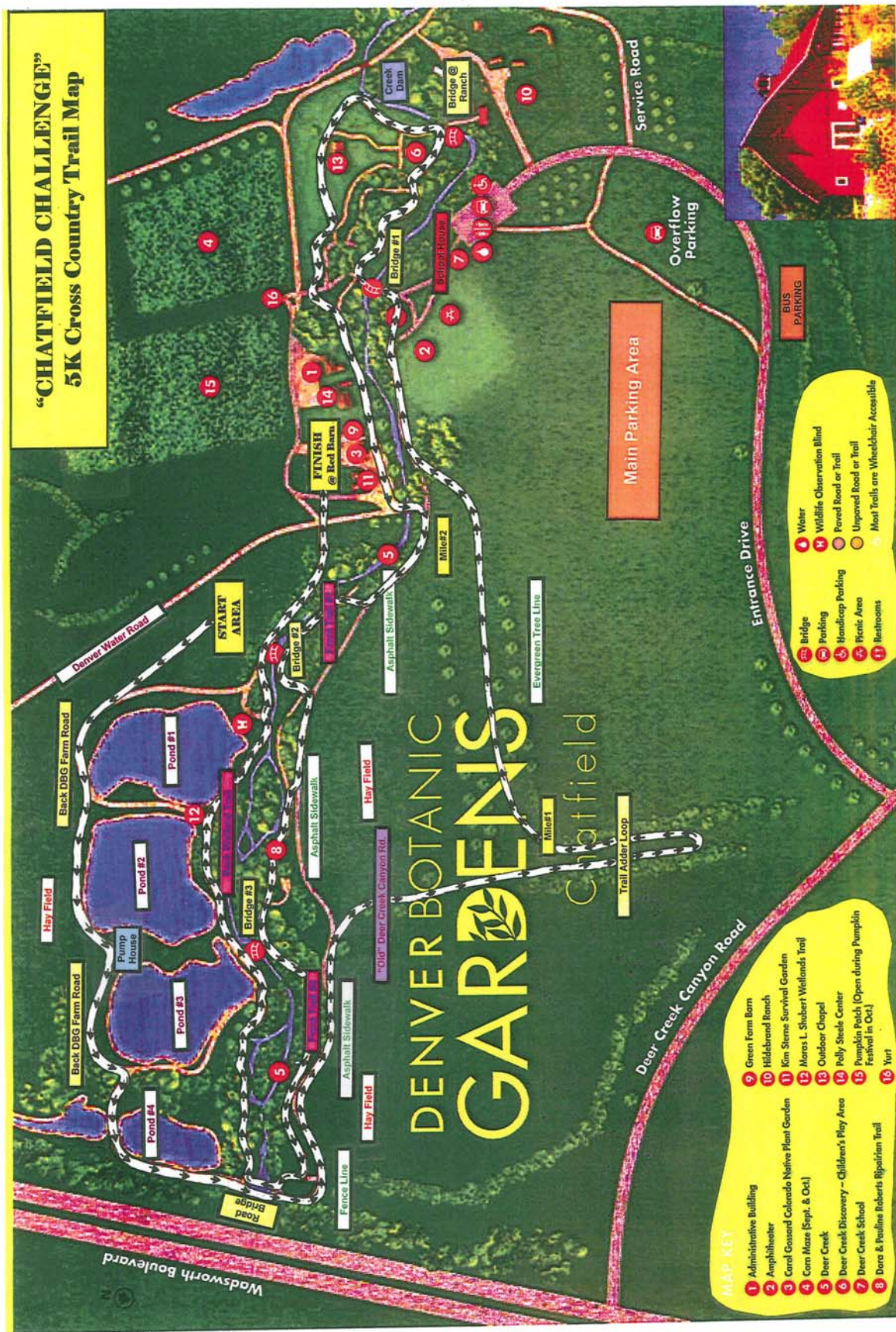

MAP KEY

- 1 Administrative Building
- 2 Amphitheater
- 3 Carol Gossard Colorado Native Plant Garden
- 4 Corn Maze (Sept. & Oct.)
- 5 Deer Creek
- 6 Deer Creek Discovery - Children's Play Area
- 7 Deer Creek School
- 8 Doris & Pauline Roberts Riparian Trail
- 9 Green Farm Barn
- 10 Hildebrand Ranch
- 11 Kim Sterne Survival Garden
- 12 Maras L. Shubert Wetlands Trail
- 13 Outdoor Chapel
- 14 Polly Steele Center
- 15 Pumpkin Patch (Open during Pumpkin Festival in Oct.)
- 16 Yurt

- Water
- Wildlife Observation Blind
- Paved Road or Trail
- Unpaved Road or Trail
- Most Trails are Wheelchair Accessible

- Bridge
- Parking
- Handicap Parking
- Picnic Area
- Restrooms

- Water
- Wildlife Observation Blind
- Paved Road or Trail
- Unpaved Road or Trail
- Most Trails are Wheelchair Accessible

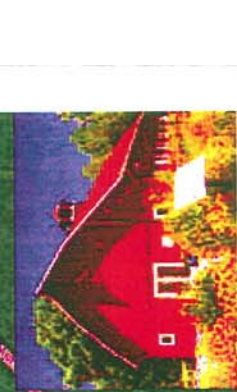

DENVER BOTANIC GARDENS
Chatfield

Wadsworth Boulevard

Deer Creek Canyon Road

Main Parking Area

Overflow Parking

Entrance Drive

Service Road

START AREA

FINISH @ Red Barn

Pond #1

Pond #2

Pond #3

Pond #4

Pump House

Back DBG Farm Road

Back DBG Farm Road

Hay Field

Hay Field

Hay Field

Hay Field

Hay Field

Hay Field

Hay Field

Asphalt Sidewalk

Asphalt Sidewalk

Asphalt Sidewalk

Asphalt Sidewalk

Asphalt Sidewalk

Asphalt Sidewalk

Asphalt Sidewalk

Asphalt Sidewalk

Asphalt Sidewalk

Asphalt Sidewalk

Asphalt Sidewalk

Asphalt Sidewalk

Asphalt Sidewalk

Asphalt Sidewalk

Asphalt Sidewalk

Asphalt Sidewalk

Asphalt Sidewalk

Asphalt Sidewalk

Asphalt Sidewalk

Asphalt Sidewalk

Asphalt Sidewalk

Asphalt Sidewalk

Asphalt Sidewalk

Asphalt Sidewalk

Asphalt Sidewalk

Asphalt Sidewalk

Asphalt Sidewalk

Asphalt Sidewalk

Asphalt Sidewalk

Asphalt Sidewalk

Asphalt Sidewalk

Asphalt Sidewalk

Asphalt Sidewalk

Asphalt Sidewalk

Asphalt Sidewalk

Asphalt Sidewalk

Asphalt Sidewalk

Asphalt Sidewalk

Asphalt Sidewalk

Asphalt Sidewalk

Asphalt Sidewalk

Asphalt Sidewalk

Asphalt Sidewalk

Asphalt Sidewalk

Asphalt Sidewalk

Asphalt Sidewalk

Asphalt Sidewalk

Asphalt Sidewalk

Asphalt Sidewalk

Asphalt Sidewalk

Asphalt Sidewalk

Asphalt Sidewalk

Asphalt Sidewalk

Asphalt Sidewalk

Asphalt Sidewalk

Asphalt Sidewalk

Asphalt Sidewalk

Asphalt Sidewalk

Asphalt Sidewalk

Asphalt Sidewalk

Asphalt Sidewalk

Asphalt Sidewalk

Asphalt Sidewalk

Asphalt Sidewalk

Asphalt Sidewalk

Asphalt Sidewalk

Asphalt Sidewalk

Asphalt Sidewalk

Asphalt Sidewalk

Asphalt Sidewalk

Asphalt Sidewalk

Asphalt Sidewalk

Asphalt Sidewalk

Asphalt Sidewalk

Asphalt Sidewalk

Asphalt Sidewalk

Asphalt Sidewalk

Asphalt Sidewalk

Asphalt Sidewalk

Asphalt Sidewalk

Asphalt Sidewalk

Asphalt Sidewalk

Asphalt Sidewalk

Asphalt Sidewalk

Asphalt Sidewalk

Asphalt Sidewalk

Asphalt Sidewalk

Asphalt Sidewalk

Asphalt Sidewalk

Asphalt Sidewalk

Asphalt Sidewalk

Asphalt Sidewalk

Asphalt Sidewalk

Asphalt Sidewalk

Asphalt Sidewalk

Asphalt Sidewalk

Asphalt Sidewalk

Asphalt Sidewalk

Asphalt Sidewalk

Asphalt Sidewalk

Asphalt Sidewalk

Asphalt Sidewalk

Asphalt Sidewalk

Asphalt Sidewalk

Asphalt Sidewalk

Asphalt Sidewalk

Asphalt Sidewalk

Asphalt Sidewalk

Asphalt Sidewalk

Asphalt Sidewalk

Asphalt Sidewalk

Asphalt Sidewalk

Asphalt Sidewalk

Asphalt Sidewalk

Asphalt Sidewalk

Asphalt Sidewalk

Asphalt Sidewalk

Asphalt Sidewalk

Asphalt Sidewalk

Asphalt Sidewalk

Asphalt Sidewalk

Asphalt Sidewalk

Asphalt Sidewalk

Asphalt Sidewalk

Asphalt Sidewalk

Asphalt Sidewalk

Asphalt Sidewalk

Asphalt Sidewalk

Asphalt Sidewalk

Asphalt Sidewalk

Asphalt Sidewalk

Asphalt Sidewalk

Asphalt Sidewalk

Asphalt Sidewalk

Asphalt Sidewalk

Asphalt Sidewalk

Asphalt Sidewalk

Asphalt Sidewalk

Asphalt Sidewalk

Asphalt Sidewalk

Asphalt Sidewalk

Asphalt Sidewalk

Asphalt Sidewalk

Asphalt Sidewalk

Asphalt Sidewalk

Asphalt Sidewalk

Asphalt Sidewalk

Asphalt Sidewalk

Asphalt Sidewalk

Asphalt Sidewalk

Asphalt Sidewalk

Asphalt Sidewalk

Asphalt Sidewalk

Asphalt Sidewalk

Asphalt Sidewalk

Asphalt Sidewalk

Asphalt Sidewalk

Asphalt Sidewalk

Asphalt Sidewalk

Asphalt Sidewalk

Asphalt Sidewalk

Asphalt Sidewalk

Asphalt Sidewalk

Asphalt Sidewalk

Asphalt Sidewalk

Asphalt Sidewalk

Asphalt Sidewalk

Asphalt Sidewalk

Asphalt Sidewalk

Asphalt Sidewalk

Asphalt Sidewalk

Asphalt Sidewalk

Asphalt Sidewalk

Asphalt Sidewalk

Asphalt Sidewalk

Asphalt Sidewalk

Asphalt Sidewalk

Asphalt Sidewalk

Asphalt Sidewalk

Asphalt Sidewalk

Asphalt Sidewalk

Asphalt Sidewalk

Asphalt Sidewalk

Asphalt Sidewalk

Asphalt Sidewalk

Asphalt Sidewalk

Asphalt Sidewalk

Asphalt Sidewalk

Asphalt Sidewalk

Asphalt Sidewalk

Asphalt Sidewalk

Asphalt Sidewalk

Asphalt Sidewalk

Asphalt Sidewalk

Asphalt Sidewalk

Asphalt Sidewalk

Asphalt Sidewalk

Asphalt Sidewalk

Asphalt Sidewalk

Asphalt Sidewalk

Asphalt Sidewalk

Asphalt Sidewalk

Asphalt Sidewalk

Asphalt Sidewalk

Asphalt Sidewalk

Asphalt Sidewalk

Asphalt Sidewalk

Asphalt Sidewalk

Asphalt Sidewalk

Asphalt Sidewalk

Asphalt Sidewalk

Asphalt Sidewalk

Asphalt Sidewalk

Asphalt Sidewalk

Asphalt Sidewalk

Asphalt Sidewalk

Asphalt Sidewalk

Asphalt Sidewalk

Asphalt Sidewalk

Asphalt Sidewalk

Asphalt Sidewalk

Asphalt Sidewalk

Asphalt Sidewalk

Asphalt Sidewalk

Asphalt Sidewalk

Asphalt Sidewalk

Asphalt Sidewalk

Asphalt Sidewalk

Asphalt Sidewalk

Asphalt Sidewalk

Asphalt Sidewalk

Asphalt Sidewalk

Asphalt Sidewalk

Asphalt Sidewalk

Asphalt Sidewalk

Asphalt Sidewalk

Asphalt Sidewalk

Asphalt Sidewalk

Asphalt Sidewalk

Asphalt Sidewalk

Asphalt Sidewalk

Asphalt Sidewalk

DENVER BOTANIC GARDENS

8500 Deer Creek Canyon Rd
Littleton, CO 80128
303.973.3705

Chatfield

Get lost in our gigantic 8.5 acre Corn Maze

PRESENTING SPONSOR: TBA

Create a fall family tradition at our Corn Maze, one of the most attended in the nation. Navigate through 8 acres of twists and turns. The maze is for all ages and includes activities for the whole family.

We invite you to get lost at this year's Denver Botanic Gardens at Chatfield's 8-acre Corn Maze – **one of the most attended corn mazes in the country.** The maze is for all ages and includes activities for the whole family. Maze design is cut in the shape of a marmot (a large ground squirrel native to the Rocky Mountains that is also the mascot for the new [Mordecai Children's Garden](#) at the Gardens' York Street location). There will also be mini-maze for the younger crowd with free admission to this smaller maze.

Anyone attending the Chatfield Challenge can take advantage of a discounted admission to the corn maze for only \$5.00.

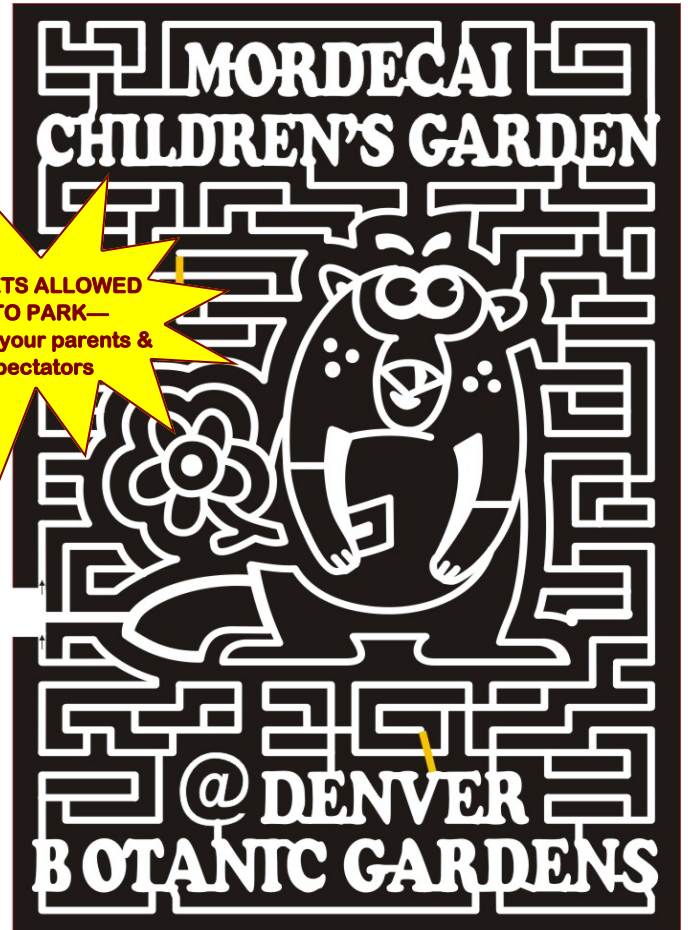

Corn Maze frequently asked questions

What is a corn maze? Corn mazes are giant puzzles that are created through rows of corn. Pathways are cut into the corn to create an intricate design that creates a challenge to walk through with its numerous dead-ends and tricky pathways.

How long will it take me to go through the maze? It will take approximately one hour to complete the maze.

What types of payment do you accept? We accept cash, credit, and debit cards. There is not an ATM available on-site.

Are pets allowed in the maze? There are no pets allowed in the Corn Maze or on the grounds of Denver Botanic Gardens at Chatfield.

GENERAL CORN MAZE INFORMATION:

Adults \$10.00; Students \$8.00; Children (4 -12) \$6.00;
Children under 3 and under are free
Purchase tickets at the Corn Maze or through TicketsWest at any King Soopers.

Date / Time:

The Corn Maze is open every Friday, Saturday, and Sunday from Sept. 10 through Oct. 31.

Fridays 4—9 p.m.

Saturdays & Sundays Noon—9 p.m.

Sundays Noon – 10 p.m.

- Enjoy tasty fall treats from our food vendors
- Includes two observation bridges that provide a bird's eye view to help you navigate
- Hayrides, and horse and pony rides will be available on the weekends for an additional cost